

Combo-Micro Valve Pneumatic Controls

1.5 cu. ft Vessel

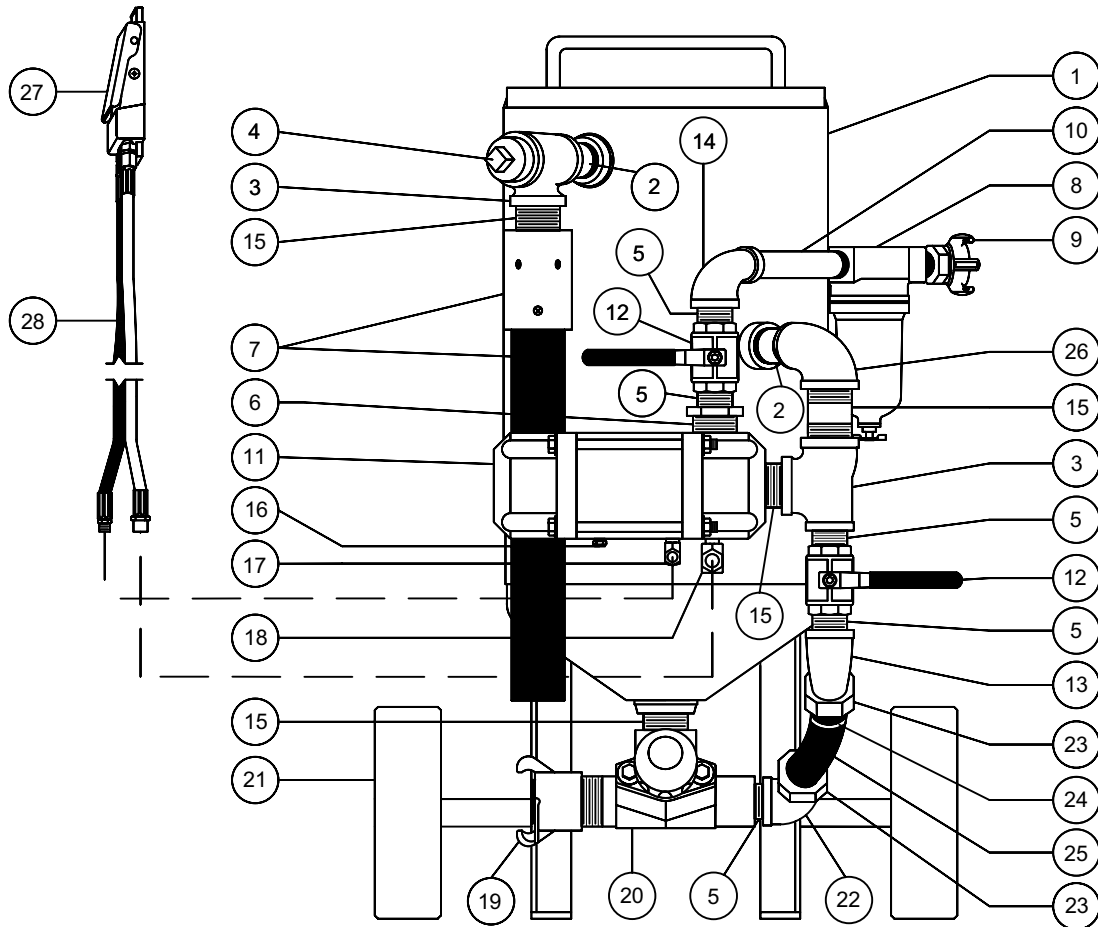

1" Piping with Combo-Micro Valve

No.	Part No.	Description	No.	Part No.	Description
1.	See page 3	Portable Vessel	16.	2014-300	Breather Vent, 1/8"
2.	3029-006-11	Nipple, 1" x 3"	17.	4203-500-00	90° Swivel, 1/8" x 1/8"
3.	3013-007-06	Reducing Tee, 1 1/4" x 1"	18.	4203-502-02	90° Swivel, 1/4" x 1/4"
4.	3014-007	Plug, 1 1/4"	19.	4214-108-01 4209-999	Blast Hose Coupling with gasket Gasket
5.	3029-006-99	Nipple, 1" x close	20.	2125-106	Micro Valve, 1" (See page 14)
6.	3026-007-06	Bushing, 1 1/4" x 1"	21.	7040-003 7046-002 7019-519	Axle (as of April, '95) Wheel Nut, 3/4"
7.	4115-005 4215-405 4104-005	Blowdown Hose Assembly Nozzle Holder Blast Hose (per foot)	22.	3006-106	90° Street Elbow, 1"
8.	2302-205-50	Moisture Separator, 3/4"	23.	4205-106 4205-106-99	Swivel Insert, 1" with gasket Gasket
9.	4208-105 4209-999	Crowfoot, 3/4" 2 lug male with gasket Gasket	24.	4228-508	Bandit Clamp
10.	3029-005-14	Nipple, 3/4" x 5"	25.	4102-006	Air Hose, 1" (per foot)
11.	2223-000	Combo Valve (See page 15)	26.	3010-007-06	90° Elbow, 1 1/4" x 1"
12.	2401-506	Ball Valve, 1" full port	27.	2263-000	Deadman, pneumatic (See page 16)
13.	3008-006	45° Street Elbow, 1"	28.	4100-501 4100-701	Twinline Hose Assembly, 55 ft Twinline Hose Assembly, 110ft
14.	3010-006-05	90° Elbow, 1" x 3/4"			
15.	3029-007-99	Nipple, 1 1/4" x close			